



Fenestra Fenix is an inwardly pivoting or pivoting and angled single frame triple glazing assembly wood-aluminium window with the external sash and frame being aluminium clad.

MEASUREMENTS AND SHAPE

The sash's maximum area is 3m², the frame's 6m². Special shaped:
Round, arched, curved and sharp cornered windows.

WOOD

Three ply laminated timber (pine) selected according to quality standard SFS 4433. Frames are fastened using finger-jointed wood laminate using weatherproof glue D4.

FINISHING

Paint (e.g. RAL catalogue) or stain (AkzoNobel TINTEX catalogue) is used.

ALUMINIUM

Aluminium parts are powder coated.

PROPERTIES

Heat retention:

U-value with standard glass is 0.83;

U-value with special glass is 0.79 (VTT estimated, measurement 1230x1480)

Sound insulation:

Standard glass $R_w = 33$ dB Special glass up to $R_w = 41$ dB

GLAZING

Triple glazed assemblies: 3K4Sel/4/4Sel-18 CU+ARG. Glazing unit thickness 48mm.

By special order safety glass, glazing assemblies for improving sound insulation and reducing UV radiation.

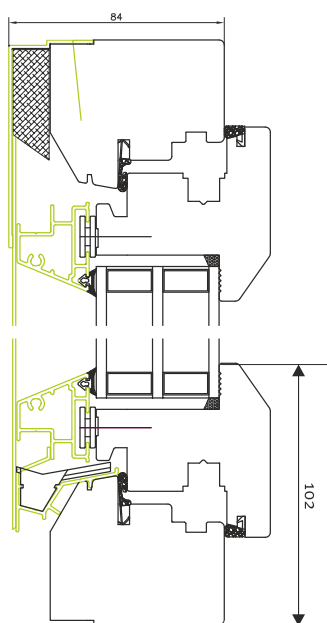

Upper/lower frame

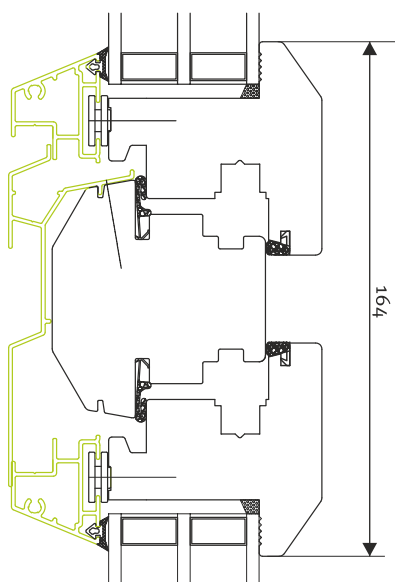

Impost

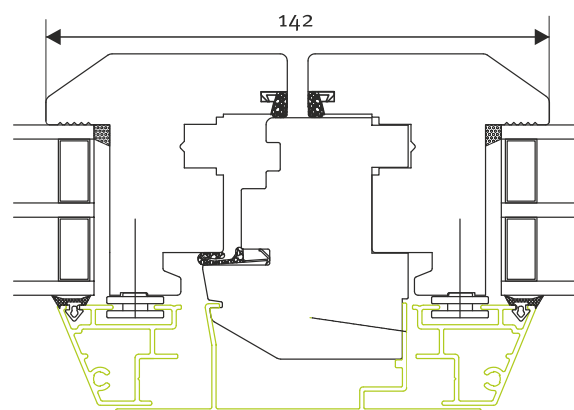

Central roller sash